

New Version / neue version

546.80.715

Fixing Details

***All Dimensions are in mm**

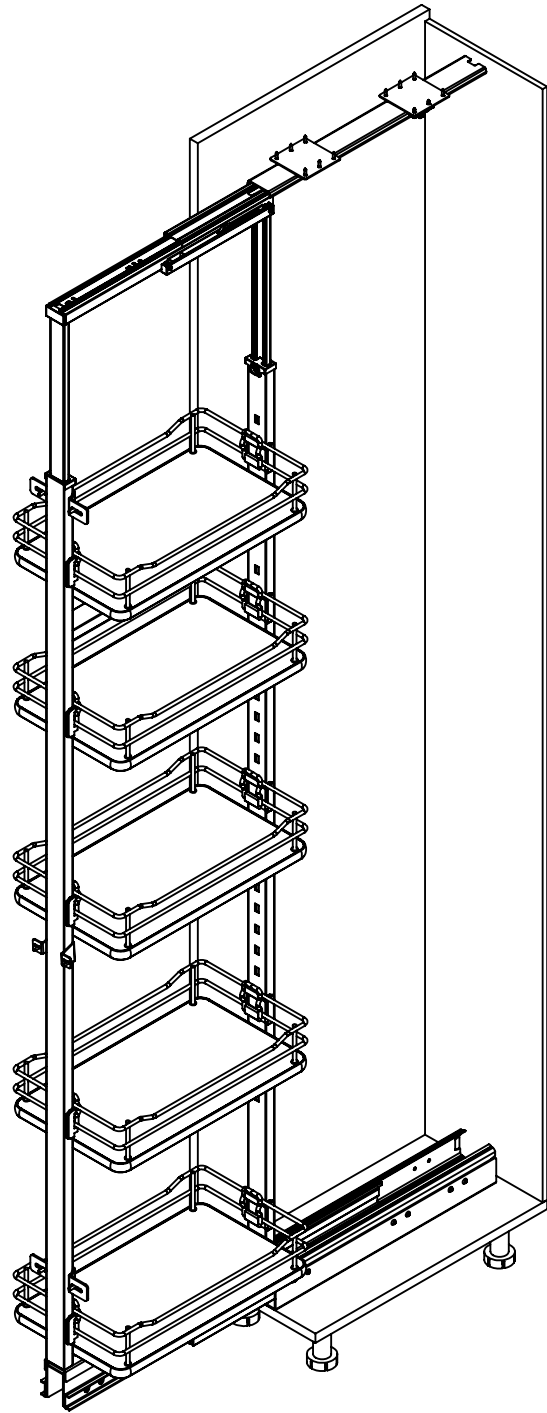

Step 01

*** Bottom Slide System Mounting**

**5x15 Chip Board Screw
(Pan Head)
Qty: 08 Nos.**

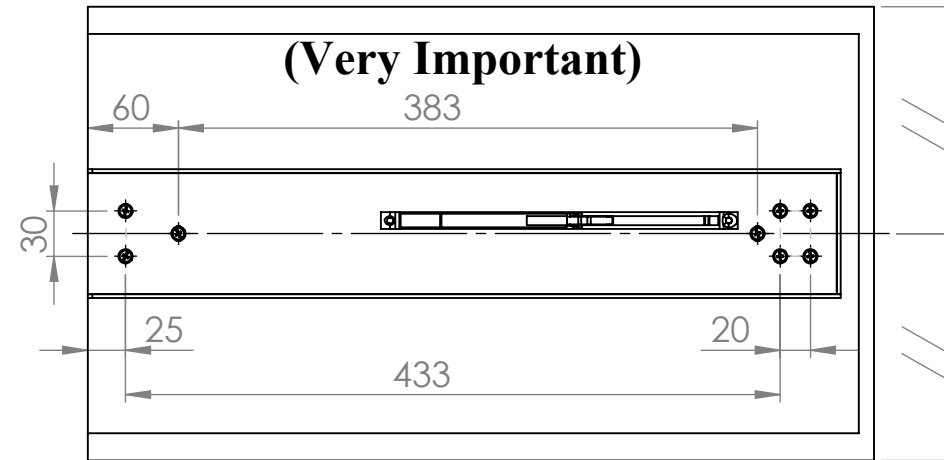
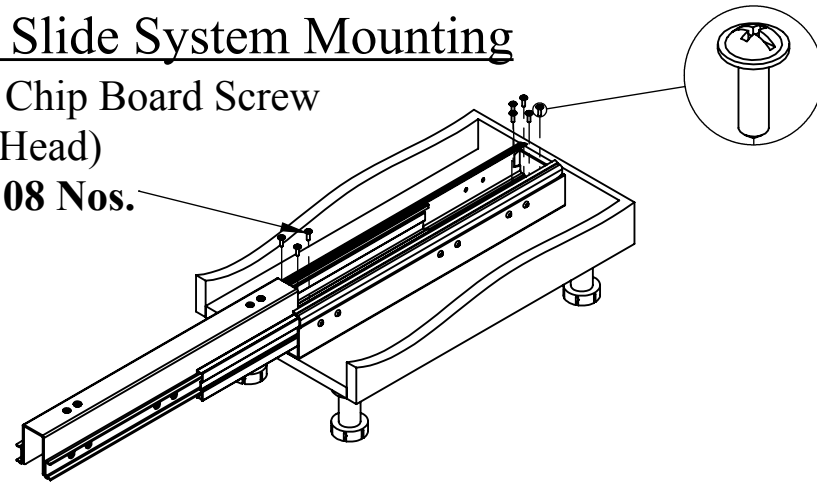

Step 02

*** Top Slide System Mounting**

**4x20 Chip Board Screw
(Pan Head)
Qty: 02 Nos.**

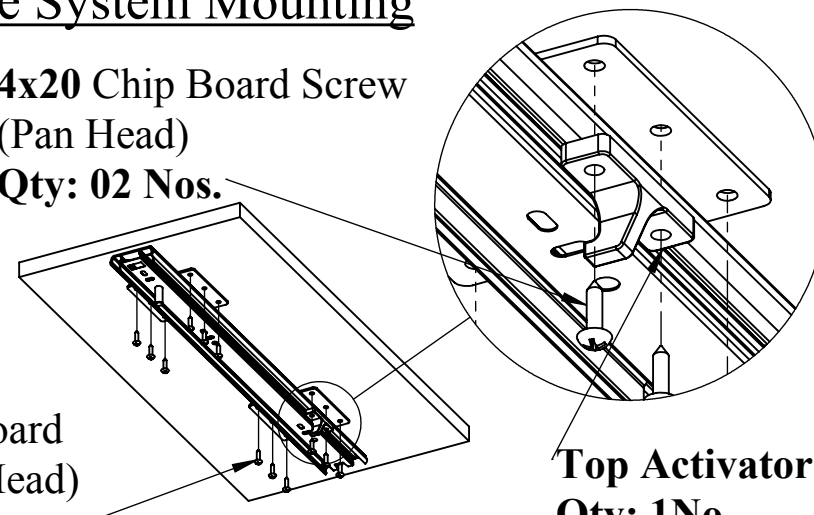

**4x15 Chip Board
Screw (Pan Head)
Qty: 10 Nos.**

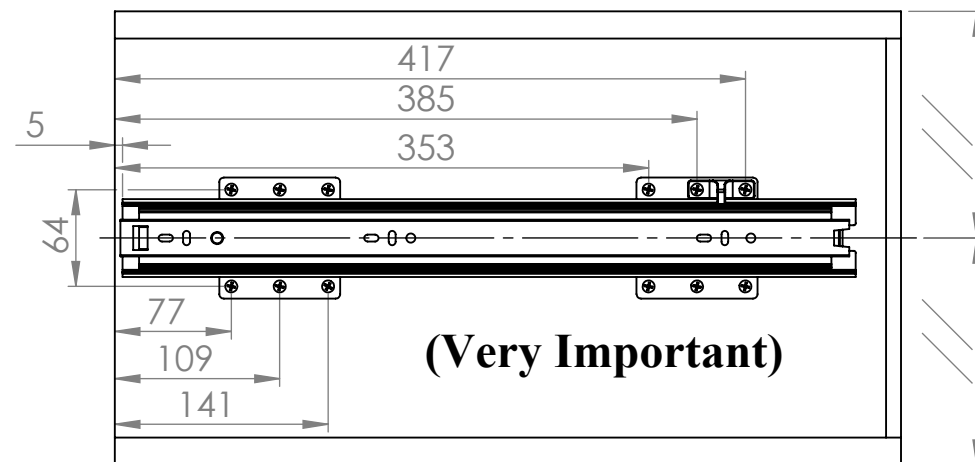

Step 03

*** Frame fixing**

**M5x16 Machine Screw
(Flat Head)
Qty: 01No.**

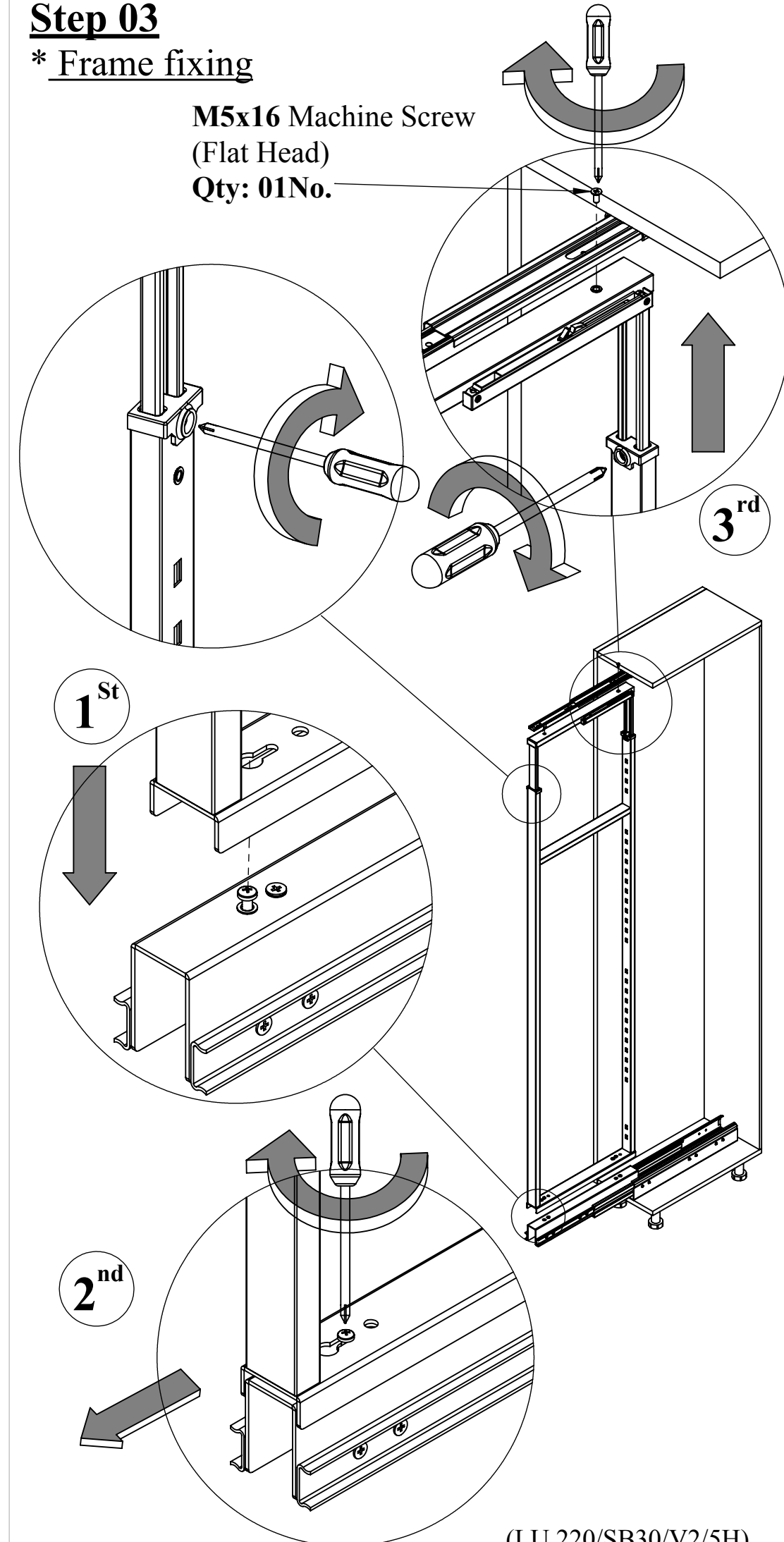

Fasteners Used

Chip Board Screw (Pan Head)	Machine Screw (Flat Head)
Machine Screw (Pan Head)	Machine Screw (Truss Head)

***Minimum Internal Cabinet Depth 500 mm**

Step 04

* Door Bracket fixing

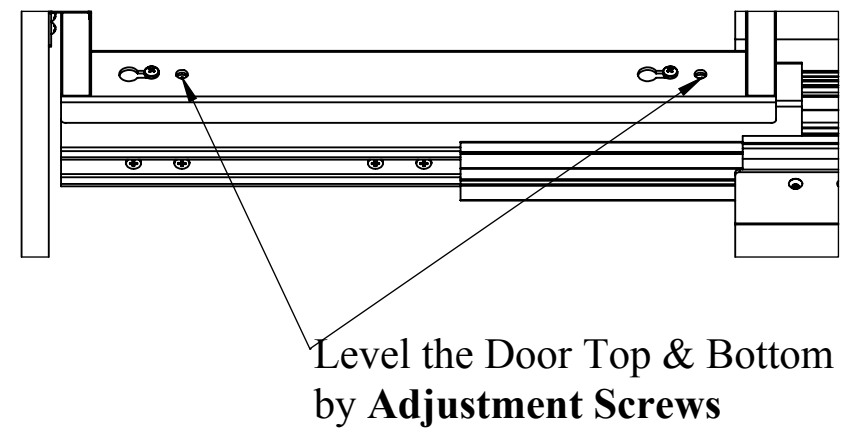
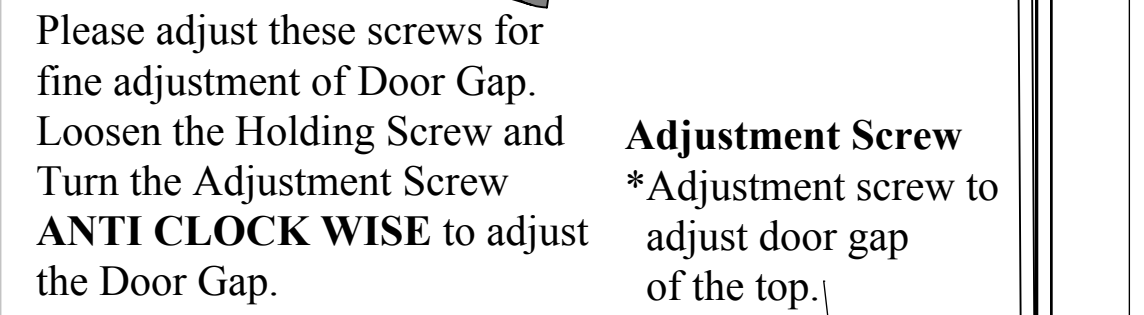
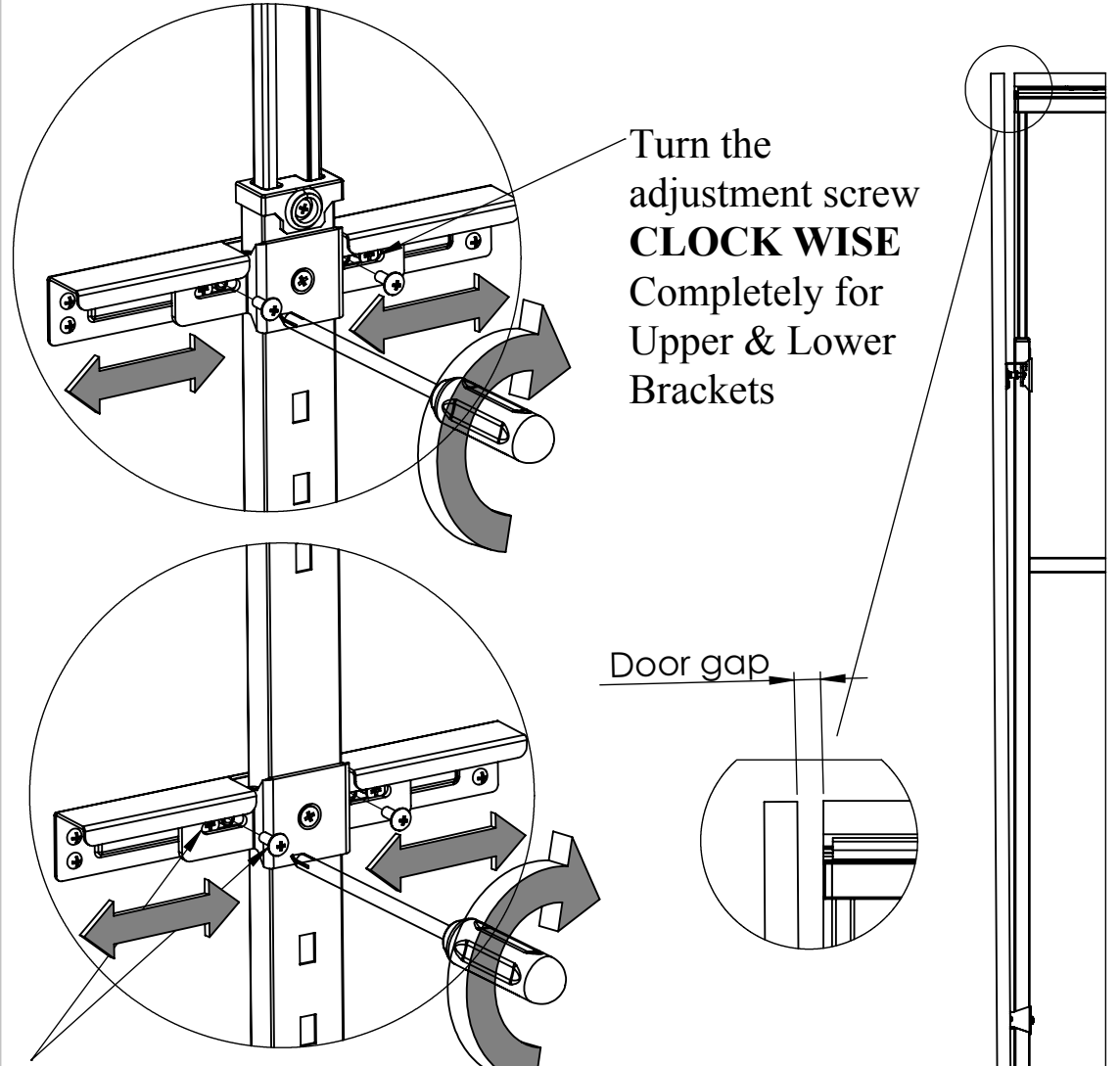
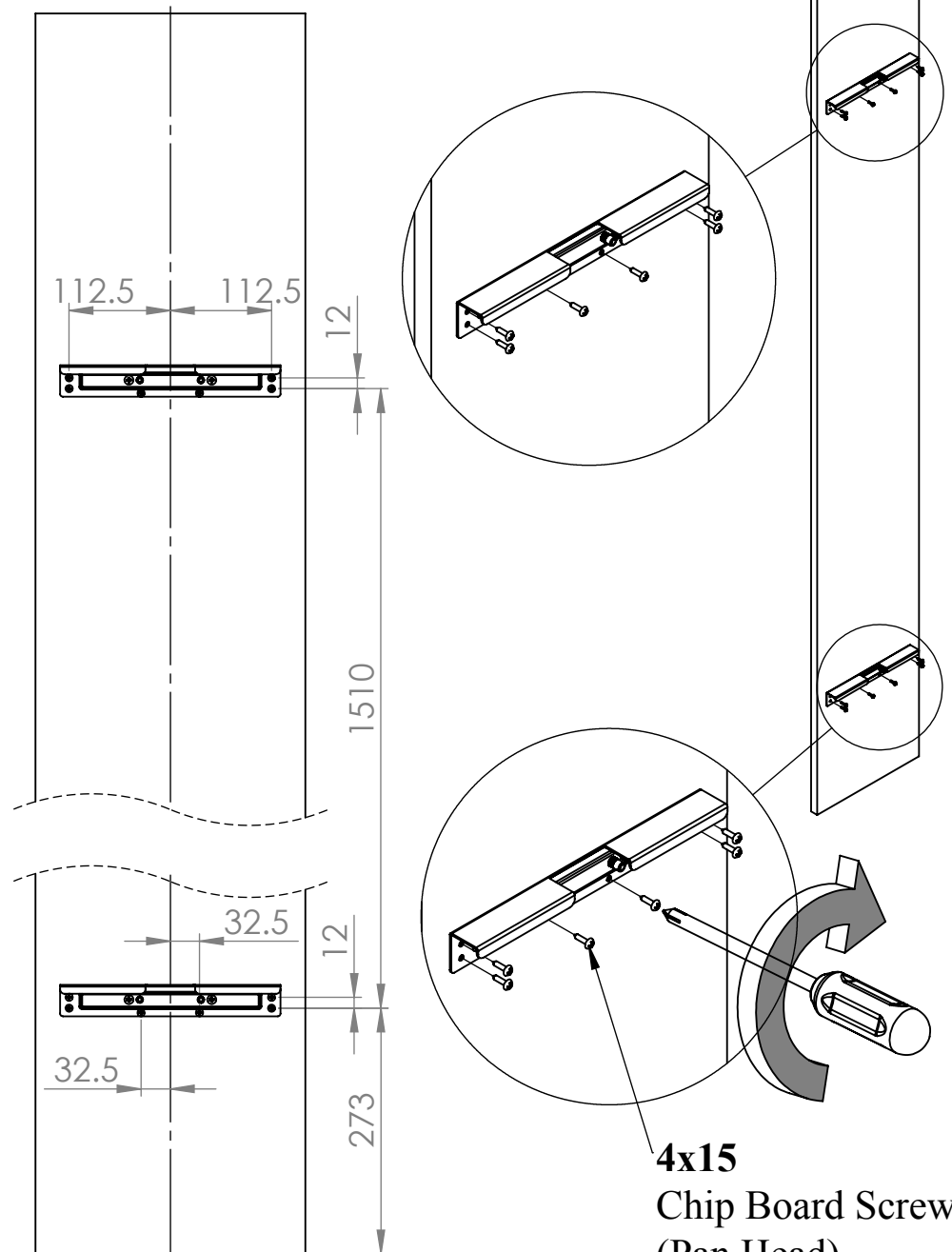

Step 06

* Basket fixing

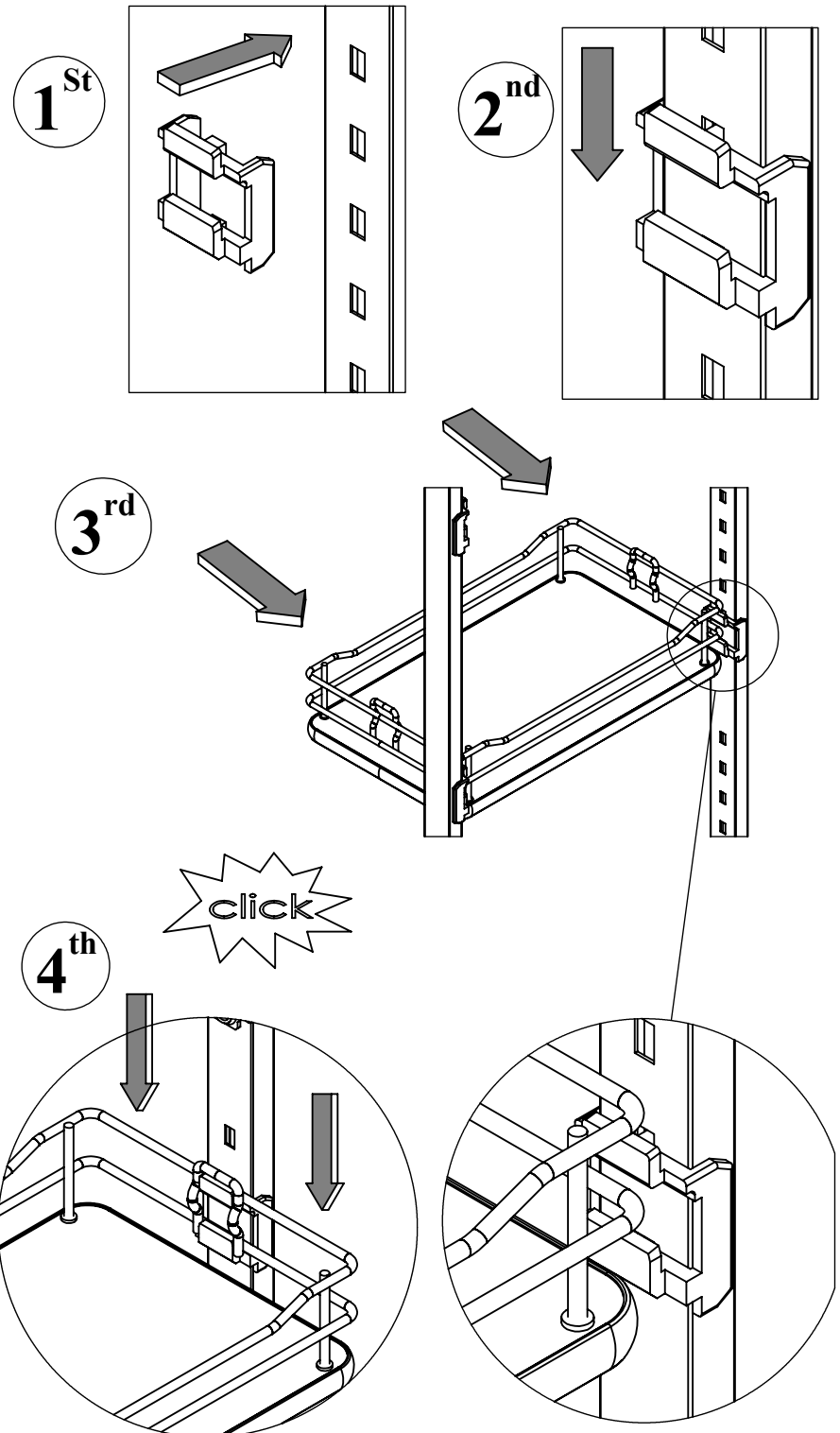

Step 05

* Door fixing

